

## 標準カットグローブスチールパイプ仕様

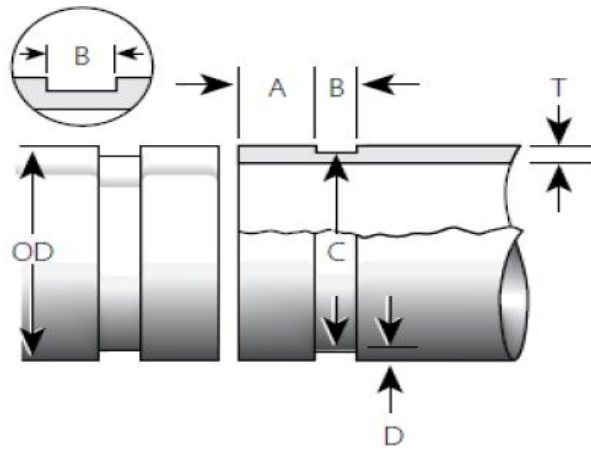

### ROベッセル/ハウジングのサイドポート標準外径

- 1" IPS GROOVE: 33.70mm
- 1.5" IPS GROOVE: 48.30mm
- 2" IPS GROOVE: 60.30mm
- 2.5" IPS GROOVE: 73.00mm
- 3" IPS GROOVE: 88.90mm
- 4" IPS GROOVE: 114.30mm

呼び径	パイプ外径及び公差			ガスケットシート A	溝幅 B	溝直径 C		溝深さ D	最小壁厚 T
	標準外径	公差				標準	公差		
ANSI in DN	in mm	+in +mm	-in -mm	±0.03 ±0.76	in ±0.03 mm ±0.76	in mm	in mm	in mm	in mm
3/4 20	1.059 26.90	0.010 0.25	0.010 0.25	0.625 15.88	0.313 7.95	0.938 23.83	-0.015 -0.38	0.056 1.42	0.113 2.87
33.0 25	1.260 32.00	0.013 0.33	0.013 0.33	0.625 15.88	0.313 7.95	1.138 28.90	-0.015 -0.38	0.063 1.60	0.133 3.38
1 25	1.327 33.70	0.013 0.33	0.013 0.33	0.625 15.88	0.313 7.95	1.190 30.23	-0.015 -0.38	0.063 1.60	0.133 3.38
38.0 32	1.496 38.00	0.016 0.41	0.016 0.41	0.625 15.88	0.313 7.95	1.370 34.80	-0.015 -0.38	0.063 1.60	0.133 3.38
1-1/4 32	1.669 42.40	0.016 0.41	0.016 0.41	0.625 15.88	0.313 7.95	1.535 38.99	-0.015 -0.38	0.063 1.60	0.133 3.38
1-1/2 40	1.900 48.30	0.019 0.48	0.019 0.48	0.625 15.88	0.313 7.95	1.775 45.09	-0.015 -0.38	0.063 1.60	0.140 3.56
57.0 50	2.244 57.00	0.024 0.61	0.024 0.61	0.625 15.88	0.313 7.95	2.120 53.85	-0.015 -0.38	0.063 1.60	0.154 3.91
2 50	2.375 60.30	0.024 0.61	0.024 0.61	0.625 15.88	0.313 7.95	2.250 57.15	-0.015 -0.38	0.063 1.60	0.154 3.91
2-1/2 65	2.875 73.00	0.029 0.74	0.029 0.74	0.625 15.88	0.313 7.95	2.720 69.09	-0.018 -0.46	0.078 1.98	0.188 4.78
76.1 65	3.000 76.10	0.029 0.74	0.029 0.74	0.625 15.88	0.313 7.95	2.845 72.26	-0.018 -0.46	0.078 1.98	0.188 4.78
3 80	3.500 88.90	0.035 0.89	0.031 0.79	0.625 15.88	0.313 7.95	3.344 84.94	-0.018 -0.46	0.078 1.98	0.188 4.78
108.0 100	4.250 108.00	0.035 0.89	0.031 0.79	0.625 15.88	0.375 9.53	4.084 103.73	-0.020 -0.51	0.083 2.11	0.203 5.16
4 100	4.500 114.30	0.035 0.89	0.031 0.79	0.625 15.88	0.375 9.53	4.334 110.08	-0.020 -0.51	0.083 2.11	0.203 5.16
133.4 125	5.250 133.40	0.039 1.0	0.031 0.79	0.625 15.88	0.375 9.53	5.084 129.13	-0.020 -0.51	0.083 2.11	0.203 5.16
139.7 125	5.500 139.70	0.039 1.0	0.031 0.79	0.625 15.88	0.375 9.53	5.335 135.50	-0.020 -0.51	0.083 2.11	0.203 5.16
5 125	5.563 141.30	0.039 1.0	0.031 0.79	0.625 15.88	0.375 9.53	5.395 137.03	-0.020 -0.51	0.084 2.13	0.203 5.16
159.0 150	6.250 159.00	0.039 1.0	0.031 0.79	0.625 15.88	0.375 9.53	6.083 154.50	-0.022 -0.56	0.085 2.16	0.219 5.56
6 150	6.625 168.30	0.063 1.60	0.031 0.79	0.625 15.88	0.375 9.53	6.455 163.96	-0.022 -0.56	0.085 2.16	0.219 5.56
8 200	8.625 219.10	0.063 1.60	0.031 0.79	0.750 19.05	0.438 11.13	8.441 214.40	-0.025 -0.64	0.092 2.34	0.238 6.05
10 250	10.750 273.00	0.063 1.60	0.031 0.79	0.750 19.05	0.500 12.70	10.562 268.28	-0.027 -0.69	0.094 2.39	0.250 6.35
12 300	12.750 323.90	0.063 1.60	0.031 0.79	0.750 19.05	0.500 12.70	12.531 318.29	-0.030 -0.76	0.109 2.77	0.279 7.09